



Report for  
**City of Bellefontaine Neighbors**  
**Dept. of Parks & Recreation**

# *Bissell Hills Park*

Master Plan Report

Summer, 2016

## ACKNOWLEDGEMENTS

*CITY OF BELLEFONTAINE NEIGHBORS*

*MARK DICKERSON | DIRECTOR OF PARKS AND RECREATION*

*DON MERZ | ALDERMAN*

*SALLY WAHLBRINK | PARK BOARD MEMBER*

*TINA SWINDLE | PARK BOARD MEMBER*

*KATHY ENDORF | PARK BOARD MEMBER*

*JUDY MANTYCH | PARK BOARD MEMBER*

*DAVE CROSS | PARK BOARD MEMBER*

*KENNETH WILKINS | PARK BOARD MEMBER*

*JANE DAVIS | PARK BOARD MEMBER*

## PLANNING TEAM

*JAY WOHLSCHLAEGER | PRINCIPAL- IN-CHARGE*

*CHRIS SANDERS | PROJECT MANAGER*



*INTRODUCTION AND BACKGROUND* 4-5  
*PUBLIC ENGAGEMENT* 6-7  
*CONCEPT PLANS* 8-9  
*FINAL MASTER PLAN* 10-11  
*COST* 12-13  
*CONCLUSION* 14-15  
*APPENDIX* 16-40



## INTRODUCTION AND BACKGROUND

Bellefontaine Neighbors engaged SWT Design in the summer of 2015 to conduct a parks needs assessment for the city parks system. Based on the findings of this assessment and the direction of the City Park Board, SWT Design has been further engaged to develop a park master plan for Bissell Hills Park. The master plan spelled out in the following pages is a product of a collaborative process involving the community, city representatives and the design team. Included in this master plan document is a summary of feedback received from the community, a series of concept plans, the final master plan and an opinion of probable construction cost for the implementation of the master plan.

Bissell Hills Park is approximately 4.4 acres in size and located at 10237 Ashbrook Dr. Bissell Hills is a popular destination for residents of the adjacent neighborhood. Currently the park features a softball field, two tennis courts, a playground and a shelter with restrooms.

Park Location







## PUBLIC ENGAGEMENT

Public engagement was a critical component throughout the master planning process. At three strategic points throughout the planning process the design team engaged the public and the Park Board. Regular coordination with the Parks Director was further key to the development of this plan.

### Public Meeting #1

Based on the findings of the parks needs assessment performed in 2015, the design team presented 3 concepts to the public at an open house event held at the park on the evening of March 15th, 2016. At this meeting community members were given an overview of the needs assessment findings and the proposed concepts. Attendees were asked to provide feedback on elements of the existing park and the proposed concepts. Elements they found most appealing for the park were identified by placing a sticker over the images on boards presented for each concept. This feedback provided a snapshot of the community's vision for the park and valuable guidance for the design team in development of the final concept for the park.

### Online Survey

Concurrent with Public Meeting #1 an online survey was opened to the public. This survey allowed members of the community unable to attend the first public meeting to provide insight as to their vision for the park. Furthermore the survey allowed for more detailed elaboration of feedback provided during the public meeting by providing space for written responses.

### Public Meeting #2

Once feedback from the first public open house and the online survey was combined with the findings of the design team to create a revised concept plan, a second public open house was held. Once again this open house was held at Bissell Hills Park and the community was invited to review the final concept plan. The second open house took place on June 21st 2016. Attendees were given the opportunity to write or sketch suggestions for revisions to the final plan. In this case a majority of the feedback received was supportive of the final concept rather than revisionary in nature.

Copies of the public feedback boards and public survey are shown in the Appendix.







## CONCEPT PLANS

### Process

In order to understand the vision of the community for Bissell Hills park the design team developed three concept plans based on input received in the need assessment plan to gather community feedback. These plans were presented with concept imagery strategically selected to offer a variety of design vernacular. The three concepts were developed with an idea of low, medium and high impact design to the site. Concept 'A' is generally an improved version of the existing park program. Concept 'B' embraces the current program but expands on the elements in layout and execution. Concept 'C' reflects a near total break from the existing program and a drastic change to the nature of the park. Presenting a variety of elements and layouts enabled the design team to narrow down a program and design aesthetic that reflects the communities long term vision of Bissell Hills Park. Elements of each concept can be detected in the final master plan, illustrating the importance of community input in the design process.

### Concept A - Renovation

Concept 'A' took an approach to design rooted in the renovation and improvement of existing features in the park and generally keeping the spatial relationships of the park intact. Key elements of this concept include a softball overlay, and improved playground, and a multi-sport court overlay in place of the existing tennis courts. The shelter in this concept pays homage to the linear design of the

existing park structure and is located in the same space. Changes include two covered patios separated by shared restrooms to allow multiple events to occupy the shelter as well as an open air plaza looking onto the softball fields.

### Concept B - Destination

Concept 'B' retained some key program elements from the existing park program including the playground and shelter. However, unlike concept 'A', concept 'B' reflects a totally new vision for these park elements. In this concept the playground begins to reflect a destination style of play that is bisected by a dry-stream feature. Furthermore, the linear shelter is replaced by an open pavilion style of architecture. Concept 'B' replaces the existing tennis courts with a basketball court and the softball field is reprogrammed as flexible open space with a loop trail. Concept 'B' places great emphasis on the park experience for the entire community balancing destination play with flexible passive recreation.

### Concept C - Nature

Concept 'C' illustrates the most drastic change from the existing park program at Bissell Hills Park. This concept redefines Bissell Hills park as a natural space within the neighborhood. An open air shelter and nature playground are nestled into a naturalized open space with both paved and soft trails.





### Concept A - Renovation



- Softball Field Overlay
- Playground Area
- Multi-Sport Court

### Concept B - Destination



- Naturalized Drainage & Open Space
- Destination Playground
- Rain Garden
- Basketball Court

### Concept C - Nature



- Naturalized Open Space
- Adventure Playground
- Birdhouses and Sculpture Area
- Natural Trail

# FINAL MASTER PLAN

## Overall

The final master plan for Bissell Hills Park is a plan that encompasses the vision of the community combined with strategic planning and design. Elements from each of the three concept plans and the existing park can be found in the final plan. The end product is a dynamic park that will serve not only the adjacent neighborhood but will be an amenity for the entire community.

## Destination Playground

Unique play features and programmed rooms define the Bissell Hills destination playground. Driven by an existing sewer easement and an opportunity to incorporate stormwater management facilities to separate regions of the playground we are able to program the playground by age and activity. Regions of the playground adjacent to the park shelter will feature young child play features. Age and intensity of play increase the with distance from the shelter. Zoning the playground in this manner allows safe integration of all age groups on the playground. Separating the playground into distinct rooms allows for a diverse play experience as well. Elements within the playground can include: iconic climbable structures, water play, nature play, swings and fitness play, and a tot lot for young children. Structures should be selected to accommodate a wide range of abilities. Inclusive design principles should be considered within the rooms of the playground. Existing large trees within the playground area and adjacent to the shelter should be preserved wherever possible and integrated in the new design of the playground and shelter.

## Multi-sport Court

Existing tennis courts are replace by a multi-sport court. This court allows for flexible programming within this area to accommodate a multitude of uses including: basketball, soccer, hockey and volleyball. Inclusion of fencing at this feature will allow the city to control access to this facility as needed. This feature should be screened from adjacent residential properties with low earthen berms and dense evergreen tree planting.

## Shelter

An open pavilion will serve as the park shelter. This pavilion should have the capacity to accommodate a minimum of 60 people to increase the rentable value. Architecturally the pavilion should reflect traditional design elements including gabled roof and clearstory. Stone cladding on columns and lighting add a level of detail that makes this a truly special space within the park system. Restroom facilities are separate from the main shelter allowing all users of the park equal access to the restroom regardless of the programming of the shelter.

## Flexible Space

An accessible loop trail encircles a combination of natural and turf open space. Native pollinator species comprise a band of native plantings that border the north and west edges of the property. Native areas should reflect an oak savanna planting style with large canopy trees scattered throughout. Within these native areas birdhouses to attract native bird species are placed. Seating nodes are placed along the loop trail allowing visitors to engage with the open space of the park. It is important that a portion of the open space remain open lawn to accommodate a plethora of flexible unprogrammed passive recreation activities. This space is perfect for picnicking, flying a kite or tossing a ball.

## Entry & Stormwater

The existing entry sign for the park is an important element to the community. For this reason, renovations to the entry of Bissell Hills Park should be restorative in nature and should retain the overall design elements of the existing entry and sign. Adjacent to the entry feature a rain garden will serve as the terminus of a new stormwater management system. Beginning with a drystream collecting water from the playground and park shelter, stormwater is collected from the south portion of the site and ultimately treated at the front of the park in a large rain garden. Interpretive signage to educate visitors on the importance of stormwater management would be a great element in this area.





**LOOP TRAIL & AMENITIES**

- PASSIVE RECREATION
- SEATING NODES ALONG TRAIL
- POTENTIAL FOR FITNESS NODES
- BIRDHOUSES



**MULTI-SPORT COURT**

- FLEXIBLE PROGRAMMING
- BASKETBALL
- TENNIS
- VOLLEYBALL
- SOCCER
- CLOSABLE / RESERVATIONS



**PAVILION**

- FLEXIBLE SHELTER SPACE
- 60+ PERSON CAPACITY
- SEPARATE RESTROOM FACILITY
- ELECTRICAL HOOK-UPS
- RENTABLE SPACE



**LAWN & LANDSCAPE**

- FLEXIBLE TURF PLAY LAWN
- LOW MAINTENANCE NATIVE LANDSCAPE
- PERIMETER PLANTINGS
- PUBLIC ART OPPORTUNITY



**PLAYGROUND**

- PLAY ROOMS INTEGRATE PLAY INTO LANDSCAPE & ALLOW FOR SEPARATION OF AGES
- ICONIC DESTINATION PLAY PIECES TO SERVE ALL AGES
- ACCESSIBLE PLAY PIECES
- WATER PLAY ELEMENTS
- NATURE PLAY ELEMENTS
- SWINGS
- DESIGN RESPECTS UTILITY EASEMENTS ON SITE TO MITIGATE FUTURE IMPACTS



**RAIN GARDEN**

- STORMWATER MANAGEMENT
- LOW MAINTENANCE NATIVE PLANT MATERIAL
- SEASONAL COLOR
- ATTRACTS POLLINATORS



# COST OPINION

Included on this sheet is a general opinion of probable construction costs for the implementation of the Bissell Hills Park master plan. The costs are based on available information obtained by the design team during the master plan phase of work. Costs are based on 2016 construction costs and are subject to fluctuation in the market place. This information is to be used in conjunction with the master plan to establish a logical sequence of budgeted projects to be implemented by the city of Bellefontaine Neighbors.

## Suggested Project Groupings/ Priorities:

- Pavilion & Restroom
- Multi-sport Court
- Trail system
- Destination Play & Rain Garden
- Native areas

1 Hardscape				
Item	Quantity	Unit	Unit Cost	Subtotal
Concrete Sidewalks (6' wide)	13,000	sf	\$6.50	\$84,500.00
Special Paving	2,300	sf	\$14.00	\$32,200.00
Colored Concrete Edging (12" wide)	800	lf	\$22.00	\$17,600.00
Playground Surfacing (Resilient rubber)	11,500	sf	\$16.00	\$184,000.00
			Subtotal	<b>\$318,300.00</b>

2 Landscape				
Item	Quantity	Unit	Unit Cost	Subtotal
Canopy Trees	25	3" Cal.	\$350.00	\$8,750.00
Ornamental Trees	5	2" Cal.	\$250.00	\$1,250.00
Evergreen Trees	6	8' Ht.	\$320.00	\$1,920.00
Turf Sod	5,500	sy	\$4.25	\$23,375.00
Planting Area (Shrubs, Perennials, Amended Topsoil, and Mulch)	5,000	sf	\$4.50	\$22,500.00
Rain Garden BMP Plantings	3,000	sf	\$16.00	\$48,000.00
Turf/Native Area (assumed some topsoil can be salvaged from site)	7,000	sy	\$3.50	\$24,500.00
			Subtotal	<b>\$130,295.00</b>

4 Miscellaneous				
Item	Quantity	Unit	Unit Cost	Subtotal
Demo and Site Prep	1	al	\$15,000.00	\$15,000.00
Earthwork and Grading	1	al	\$10,000.00	\$10,000.00
Pavilion Shelter (60 person)	1	ea	\$75,000.00	\$75,000.00
Restroom Facilities (Male/female/family)	1	ea	\$250,000.00	\$250,000.00
Signage/Sculpture	1	al	\$20,000.00	\$20,000.00
Multi-Sport Court	1	al	\$200,000.00	\$200,000.00
Waterplay Area	1	al	\$125,000.00	\$125,000.00
Site Furnishings	1	al	\$30,000.00	\$30,000.00
Destination Playground Equipment	1	al	\$200,000.00	\$200,000.00
			Subtotal	<b>\$925,000.00</b>

Sub total: \$1,373,595.00

8% Mobilization	\$109,887.60
10% Construction Contingency	\$137,359.50
<b>Sub total:</b>	<b>\$1,620,842.10</b>

9% Design and Engineering Fees	\$145,875.79
6% Construction Observation Services	\$97,250.53
<b>Grand Total:</b>	<b>\$1,863,968.42</b>

\* Cost Opinion does not include site lighting, site utilities.

**KEY**

- |                   |                 |
|-------------------|-----------------|
| ea. - each        | al. - allowance |
| lf. - linear foot | Cal. - caliper  |
| sy. - square yard | Ht. - height    |
| sf. - square foot |                 |







## CONCLUSION

### Next Steps

The master plan process is only the first step in the successful improvement of Bissell Hills Park. Following the completion of this planning effort there are several steps to be taken by the city to continue on the path to master plan implementation.

### Formal Adoption of the Plan

The first step in the implementation of the master plan is for the city to formally adopt the master plan as the future vision of the park. Following the adoption of the plan steps can be taken towards implementation.

### Project Selection / Phasing

Once the plan is formally accepted the city should decide which portions of the master plan are priority for implementation. Included in this decision must be considerations for sequencing of work so that early work does not impede future phases. Another consideration for the selection of projects is budget. A balance must be sought between the desire of the community for improvements and the availability of funding. An example of this would be the multi-sport court in comparison to the shelter. While the shelter improvements may be a higher priority to the community the cost associated with them may make the development of the multi-sport court a more feasible first phase of work.

### Community Engagement

As projects are selected for implementation and design services are engaged to develop construction documentation, park staff and the Park Board should continue a program of community engagement. Support that was gained during the master planning process should be fostered throughout implementation and used to guide implementation priorities and phasing.

### Pursuing Funding

A number of funding sources are available for municipal park improvements. The City of Bellefontaine Neighbors should explore viable funding resources based on existing situations while remaining open to new opportunities based on future studies and planning. A list of potential funding sources is included below.

- St. Louis County Municipal Parks Grant (Local)
- Land and Water Conservation Fund (Federal)
- Landmark Local Parks Program (State)
- Recreational Trails Program (State)
- Back to nature STL Grant (Local)
- Community Conservation Grant (State)

### Project Implementation

Once specific improvements are selected and funding is identified the next step of implementation is to develop design drawings and engage contractors for construction of the selected improvements.





### LOOP TRAIL & AMENITIES

- PASSIVE RECREATION
- SEATING NODES ALONG TRAIL
- POTENTIAL FOR FITNESS NODES
- BIRDHOUSES



### MULTI-SPORT COURT

- FLEXIBLE PROGRAMMING
- BASKETBALL
- TENNIS
- VOLLEYBALL
- SOCCER
- CLOSABLE / RESERVATIONS



### PAVILION

- FLEXIBLE SHELTER SPACE
- 60+ PERSON CAPACITY
- SEPARATE RESTROOM FACILITY
- ELECTRICAL HOOK-UPS
- RENTABLE SPACE



### LAWN & LANDSCAPE

- FLEXIBLE TURF PLAY LAWN
- LOW MAINTENANCE NATIVE LANDSCAPE
- PERIMETER PLANTINGS
- PUBLIC ART OPPORTUNITY



### PLAYGROUND

- PLAY ROOMS INTEGRATE PLAY INTO LANDSCAPE & ALLOW FOR SEPARATION OF AGES
- ICONIC DESTINATION PLAY PIECES TO SERVE ALL AGES
- ACCESSIBLE PLAY PIECES
- WATER PLAY ELEMENTS
- NATURE PLAY ELEMENTS
- SWINGS
- DESIGN RESPECTS UTILITY EASEMENTS ON SITE TO MITIGATE FUTURE IMPACTS



### RAIN GARDEN

- STORMWATER MANAGEMENT
- LOW MAINTENANCE NATIVE PLANT MATERIAL
- SEASONAL COLOR
- ATTRACTS POLLINATORS







# *Appendix*





# PUBLIC MEETING #1 | CONCEPT 1

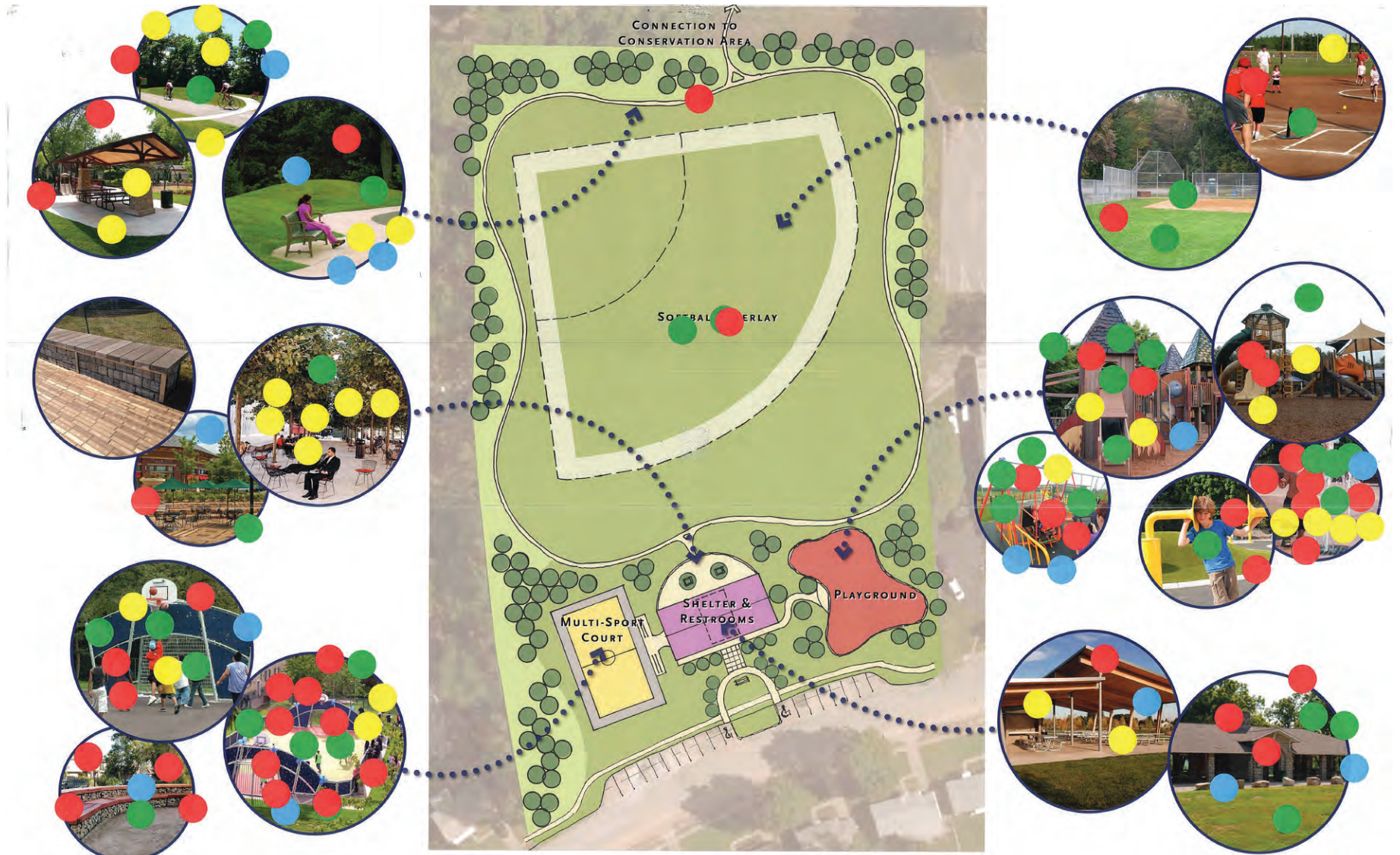



PUBLIC MEETING #1 | CONCEPT 2





# PUBLIC MEETING #1 | CONCEPT 3



# ONLINE SURVEY

## City of Bellefontaine Neighbors - Bissell Hills Park Master Plan

### Public Input Meeting #1 Feedback

#### 1. Are you a resident of Bellefontaine Neighbors

- Yes
- No

#### 2. How often would you say you visit Bissell Hills Park?

- Daily
- Weekly
- Monthly
- Yearly
- Never

#### Existing Conditions



#### 3. How do you use the park? What amenities or activities do you use in the park?

#### 4. What improvements would you like to see made to Bissell Hills Park? Why?

Below are the three concepts presented at the March 15, 2016 Public Meeting #1 for the Bissell Hills Park Master Plan. Please review the concepts and provide any thoughts you have on how these concepts address your concerns and desires for the park. These are not final concepts, but rather initial ideas for the park based on feedback received in the Parks System Needs Assessment performed last year, and evaluation of the park conditions.

If you have a preferred concept or elements of individual concepts you are invited to include that information. If you have thoughts for the park that are not shown in these concepts please include you comments in the input box below the concepts.

#### Concept A

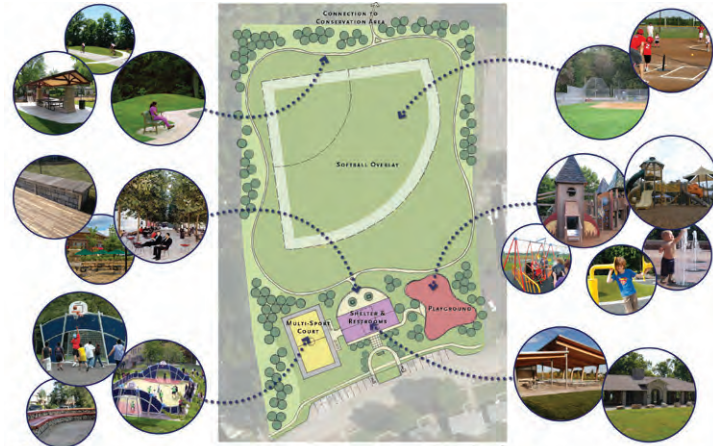



# ONLINE SURVEY

5. Please provide your thoughts on Concept A overall, or the individual elements within the plan. Individual elements may include the locations or types of shelters, playgrounds, sports courts and fields, trails, landscape, parking, etc.

## Concept B



6. Please provide your thoughts on Concept B overall, or the individual elements within the plan. Individual elements may include the locations or types of shelters, playgrounds, sports courts and fields, trails, landscape, parking, etc.

## Concept C



7. Please provide your thoughts on Concept C overall, or the individual elements within the plan. Individual elements may include the locations or types of shelters, playgrounds, sports courts and fields, trails, landscape, parking, etc.

8. Please provide any comments regarding items not included in the concepts, or general comments regarding the future of Bissell Hills Park ?

Thank you for your time to complete this input form.

# ONLINE SURVEY RESULTS

## Q1 Are you a resident of Bellefontaine Neighbors

Answered: 15 Skipped: 1

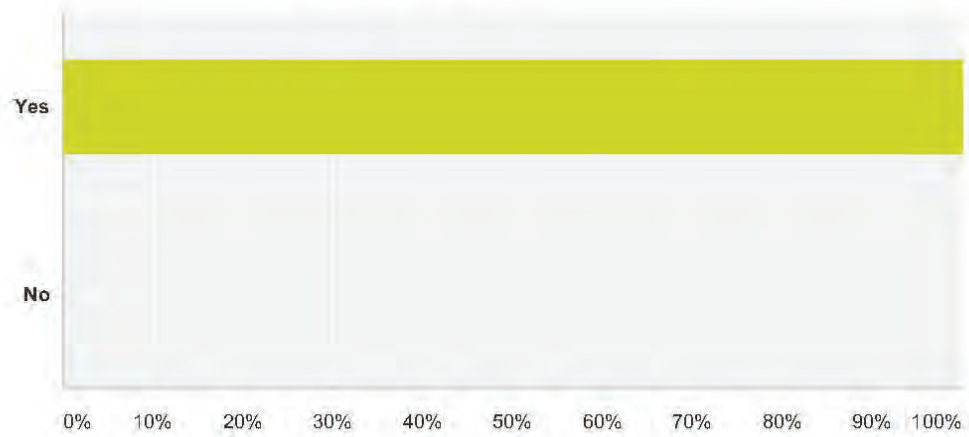

Answer Choices	Responses
Yes	100.00% 15
No	0.00% 0
<b>Total</b>	<b>15</b>





# ONLINE SURVEY RESULTS

## Q2 How often would you say you visit Bissell Hills Park?

Answered: 16 Skipped: 0

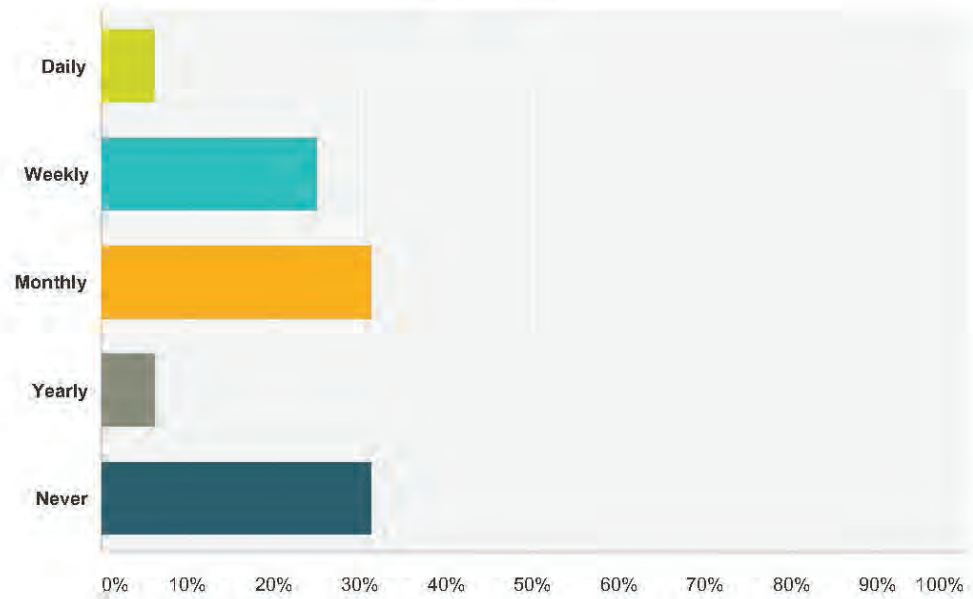

Answer Choices	Responses
Daily	6.25% 1
Weekly	25.00% 4
Monthly	31.25% 5
Yearly	6.25% 1
Never	31.25% 5
<b>Total</b>	<b>16</b>

## ONLINE SURVEY RESULTS

### Q3 How do you use the park? What amenities or activities do you use in the park?

Answered: 10 Skipped: 6

#	Responses	Date
1	We like taking our dog for a walk and letting him run a little bit. Also, I have gone to numerous BBQs at the pavilion.	3/23/2016 8:38 AM
2	The shelter and rest rooms	3/21/2016 10:24 AM
3	playground shelter tennis courts	3/18/2016 10:51 AM
4	Playground	3/16/2016 8:44 PM
5	walk dog, sit on bench	3/16/2016 5:27 PM
6	Trail to walk	3/16/2016 3:22 PM
7	When my kids were younger we used it OFTEN...now basically for the pavilion.	3/16/2016 11:42 AM
8	I did not know there is a park available for public use	3/16/2016 11:39 AM
9	Walking	3/16/2016 11:19 AM
10	n/a	3/16/2016 6:18 AM





## ONLINE SURVEY RESULTS

### Q4 What improvements would you like to see made to Bissell Hills Park? Why?

Answered: 9 Skipped: 7

#	Responses	Date
1	I would love to see an updated pavilion; a walking path around the park along with benches; landscaping with natural habitat features; and a kid-friendly playground.	3/23/2016 8:38 AM
2	The shelter and rest room need improvement.	3/21/2016 10:24 AM
3	enlarge the playground area: *include at least one expression swing (allows adult to swing with their small child) <a href="http://www.gametime.com/product/PrimeTime-Solo-Expression-Swing/">http://www.gametime.com/product/PrimeTime-Solo-Expression-Swing/</a> *include two G-Force swings (easier to put child into and take out of seat) <a href="https://www.especialneeds.com/g-force-swing-seat.html">https://www.especialneeds.com/g-force-swing-seat.html</a> * see playgrounds at Tower Grove Park: there are two playgrounds, one for younger children, and one for older children. These playgrounds also have some unusual pieces of equipment that kids love.	3/18/2016 10:51 AM
4	Better playground equipment like what Stl county has at the park behind the police department... The parent toddler swings are perfect...	3/16/2016 8:44 PM
5	dog area	3/16/2016 5:27 PM
6	Restrooms at different spots	3/16/2016 3:22 PM
7	new shelter, restrooms...a splash pad, flowers, a walking and/or biking trail, ball field, a sports court, benches, new trash receptacles, new picnic tables	3/16/2016 11:42 AM
8	The facilities are old and dated, plus there are drainage problems that could pose danger to park visitors. Not many people play tennis in this area anymore so a basketball court would be used quite often.	3/15/2016 8:55 PM
9	Remove the tennis courts and put in basketball courts. Or a skateboard area. Something the children might play on. I don't see anyone ever on the tennis court.	3/15/2016 7:46 PM

## ONLINE SURVEY RESULTS

**Q5 Please provide your thoughts on Concept A overall, or the individual elements within the plan. Individual elements may include the locations or types of shelters, playgrounds, sports courts and fields, trails, landscape, parking, etc.**

Answered: 12 Skipped: 4

#	Responses	Date
1	I like the multi-sport concept although not the softball overlay. Over the years, I haven't seen anyone utilizing the fields. I would like to see an open space for some sort of pick-up game or wiffle ball.	3/23/2016 8:38 AM
2	I think the park is to small for a divided shelter	3/21/2016 10:24 AM
3	love the fountains in the playground area, like the shelter and restroom area (especially the paved areas for chairs, like basket ball area	3/18/2016 10:51 AM
4	I despise the idea of outdoor basketball courts at this location... I feel like it would draw a bad crowd that would be unsupervised	3/16/2016 8:44 PM
5	I like "A" think is the best one!!!	3/16/2016 6:32 PM
6	luv it	3/16/2016 5:27 PM
7	Very nice	3/16/2016 3:22 PM
8	I like the ball field in the back, the large seating/eating area in the middle and that multi-sport court!	3/16/2016 11:42 AM
9	This model limits the use of the property to primarily softball, basketball and a playground	3/16/2016 11:39 AM
10	not much different than what is there now.	3/16/2016 6:18 AM
11	The gabion block seating is simple, eye appealing, and stable. I like the rest rooms in the middle of the shelter for the buffer factor from a "simple" basketball court if someone has rented the other side of the shelter. The walking trail is a must! The traditional shelter looks the best since the modern shelter looks like 1950-1960's (when these parks were created?) :) Benches and trash receptacles are also important along the trail.	3/15/2016 8:55 PM
12	Looks nice.	3/15/2016 7:46 PM





## ONLINE SURVEY RESULTS

**Q6 Please provide your thoughts on Concept B overall, or the individual elements within the plan. Individual elements may include the locations or types of shelters, playgrounds, sports courts and fields, trails, landscape, parking, etc.**

Answered: 12 Skipped: 4

#	Responses	Date
1	I love the fitness trail and destination playground. I do not like the basketball courts.It seems too limiting.	3/23/2016 8:38 AM
2	I like this concept no sure on the basketball court	3/21/2016 10:24 AM
3	like the fitness trail, the naturalized drainage area, and rain garden	3/18/2016 10:51 AM
4	I prefer Concept B. I think many individuals would utilize the basketball courts. I also like the rain garden	3/16/2016 10:03 PM
5	Love a "fitness trail" concept!!! No basketball please!	3/16/2016 8:44 PM
6	looks nice too	3/16/2016 5:27 PM
7	Very nice	3/16/2016 3:22 PM
8	I LOVE the flowers/landscaping, the large pavilion area and the fitness trail.	3/16/2016 11:42 AM
9	The walking trail is a wonderful addition that can be used by more people than the softball field. The rain garden is a nice touch along with the basketball courts and the landscaping.	3/16/2016 11:39 AM
10	like the fitness trail, not sure about the basketball court. it would keep some of the kids from playing ball in the streets, but could bring other problems to the park.	3/16/2016 6:18 AM
11	The open space/native area will be helpful for less mowing, plus great for pollinators. I think the basketball court is important in this park, but the court needs buffering from the close neighbors. The trail could have benches and or workout stations. A few parks have pages of library books (printed off by a local county library) under hard plastic on a post. They are placed around the trail so that youngsters and their parents can read the book as they walk or run along the trail. The book is changed every few weeks. Librarians always have something to suggest.	3/15/2016 8:55 PM
12	Like B better.	3/15/2016 7:46 PM

## ONLINE SURVEY RESULTS

**Q7 Please provide your thoughts on Concept C overall, or the individual elements within the plan. Individual elements may include the locations or types of shelters, playgrounds, sports courts and fields, trails, landscape, parking, etc.**

Answered: 11 Skipped: 5

#	Responses	Date
1	Again, I love the fitness trail and the adventure playground, but I would like to have the naturalized open space not as big.	3/23/2016 8:38 AM
2	like this concept the best Feel we need a sports court or spray pad but no sure where to put it.	3/21/2016 10:24 AM
3	like how it connects to the conservation area, like the birdhouses and sculptures	3/18/2016 10:51 AM
4	This is theBEST concept! I feel with more trails and a bigger playground, it will be more family friendly!!! Without a basketball court, there won't be large INTIMIDATING crowds gathering. I have two very young children and have seen the basketball crowds that play here and would never take my kids to a park where they are playing... Too dangerous.	3/16/2016 8:44 PM
5	Very nice	3/16/2016 3:22 PM
6	I really like the new playground, the birdhouses and the round, open pavilion!	3/16/2016 11:42 AM
7	I like this concept best. Removing the basketball courts makes the area more family friendly. Will the adventure playground have some features that are accessible to disabled people?	3/16/2016 11:39 AM
8	I do like this concept because it offers diversity of things to do.	3/16/2016 11:19 AM
9	this seems like the best concept. i don't currently see much use of the park outside of the shelter area.	3/16/2016 6:18 AM
10	Love the idea of the birdhouses! Have seen some on golf courses. The land slide and minimal grade climbing feature are great ideas! I also like the natural walking/running paths. The frisbee golf is a good idea. Are the log tops a path? I like it!	3/15/2016 8:55 PM
11	C is good if no youth sports are played @ Bissell Park any more. I don't have children living here anymore.	3/15/2016 7:46 PM





## ONLINE SURVEY RESULTS

### Q8 Please provide any comments regarding items not included in the concepts, or general comments regarding the future of Blssell Hills Park ?

Answered: 6 Skipped: 10

#	Responses	Date
1	Thank you for your help with trying to give the community a much needed uplift to our park.	3/23/2016 8:38 AM
2	The playground area needs to be enlarged. What we have now does not allow smaller children a safe place to play when there are bigger children at the playground at the same time. Many children who use this playground now like to play dodge ball. This really makes it unsafe for younger children when the older children are playing dodge ball. You may want to consult with Christine Kulla-Branz (a resident/Roxton). She has experience in designing playgrounds.	3/18/2016 10:51 AM
3	100% love the last concept!!! Sculptures and trails draw photography crowds and family fun... Adding a playground to this would very much be more appealing to the family type crowds! Especially with young kids!	3/16/2016 8:44 PM
4	Maintain the park	3/16/2016 3:22 PM
5	I am a long-time resident and am REALLY looking forward to seeing the park renewed!!	3/16/2016 11:42 AM
6	I think the money could be better used on more vital services. There are many beautiful parks in St Louis county.	3/15/2016 11:05 PM

# ONLINE SURVEY RESULTS

City of Bellefontaine Neighbors - Bissell Hills Park Master Plan

City of Bellefontaine Neighbors - Bissell Hills Park Master Plan

#1

COMPLETE



Collector: Web Link 2 (Web Link)  
 Started: Tuesday, March 15, 2016 7:36:24 PM  
 Last Modified: Tuesday, March 15, 2016 7:45:53 PM  
 Time Spent: 00:09:28  
 IP Address: 97.85.163.250

#2

COMPLETE



Collector: Web Link 2 (Web Link)  
 Started: Tuesday, March 15, 2016 8:07:35 PM  
 Last Modified: Tuesday, March 15, 2016 8:55:16 PM  
 Time Spent: 00:47:41  
 IP Address: 70.238.131.152

PAGE 1: Public Input Meeting #1 Feedback

PAGE 1: Public Input Meeting #1 Feedback

Q1: Are you a resident of Bellefontaine Neighbors  Yes  No

Q2: How often would you say you visit Bissell Hills Park?  Never  Sometimes  Often

Q3: How do you use the park? What amenities or activities do you use in the park? *Respondent skipped this question*

Q4: What improvements would you like to see made to Bissell Hills Park? Why?  
 Remove the tennis courts and put in basketball courts. Or a skateboard area. Something the children might play on. I don't see anyone ever on the tennis court.

Q5: Please provide your thoughts on Concept A overall, or the individual elements within the plan. Individual elements may include the locations or types of shelters, playgrounds, sports courts and fields, trails, landscape, parking, etc.  
 Looks nice.

Q6: Please provide your thoughts on Concept B overall, or the individual elements within the plan. Individual elements may include the locations or types of shelters, playgrounds, sports courts and fields, trails, landscape, parking, etc.  
 Like B better.

Q7: Please provide your thoughts on Concept C overall, or the individual elements within the plan. Individual elements may include the locations or types of shelters, playgrounds, sports courts and fields, trails, landscape, parking, etc.  
 C is good if no youth sports are played @ Bissell Park any more. I don't have children living here anymore.

Q8: Please provide any comments regarding items not included in the concepts, or general comments regarding the future of Bissell Hills Park? *Respondent skipped this question*

Q1: Are you a resident of Bellefontaine Neighbors  Yes  No

Q2: How often would you say you visit Bissell Hills Park?  Never  Sometimes  Often

Q3: How do you use the park? What amenities or activities do you use in the park? *Respondent skipped this question*

Q4: What improvements would you like to see made to Bissell Hills Park? Why?  
 The facilities are old and dated, plus there are drainage problems that could pose danger to park visitors. Not many people play tennis in this area anymore so a basketball court would be used quite often.

Q5: Please provide your thoughts on Concept A overall, or the individual elements within the plan. Individual elements may include the locations or types of shelters, playgrounds, sports courts and fields, trails, landscape, parking, etc.  
 The gablon block seating is simple, eye appealing, and stable. I like the rest rooms in the middle of the shelter for the buffer factor from a "simple" basketball court if someone has rented the other side of the shelter. The walking trail is a must! The traditional shelter looks the best since the modern shelter looks like 1950-1960's (when these parks were created?) :) Benches and trash receptacles are also important along the trail.

Q6: Please provide your thoughts on Concept B overall, or the individual elements within the plan. Individual elements may include the locations or types of shelters, playgrounds, sports courts and fields, trails, landscape, parking, etc.  
 The open space/native area will be helpful for less mowing, plus great for pollinators. I think the basketball court is important in this park, but the court needs buffering from the close neighbors. The trail could have benches and or workout stations. A few parks have pages of library books (printed off by a local county library) under hard plastic on a post. They are placed around the trail so that youngsters and their parents can read the book as they walk or run along the trail. The book is changed every few weeks. Librarians always have something to suggest.

Q7: Please provide your thoughts on Concept C overall, or the individual elements within the plan. Individual elements may include the locations or types of shelters, playgrounds, sports courts and fields, trails, landscape, parking, etc.  
 Love the idea of the birdhouses! Have seen some on golf courses. The land slide and minimal grade climbing feature are great ideas! I also like the natural walking/running paths. The frisbee golf is a good idea. Are the log tops a path? I like it!

Q8: Please provide any comments regarding items not included in the concepts, or general comments regarding the future of Bissell Hills Park? *Respondent skipped this question*





# ONLINE SURVEY RESULTS

City of Bellefontaine Neighbors - Bissell Hills Park Master Plan

City of Bellefontaine Neighbors - Bissell Hills Park Master Plan

#3

COMPLETE



Collector: Web Link 2 (Web Link)  
 Started: Tuesday, March 15, 2016 8:54:35 PM  
 Last Modified: Tuesday, March 15, 2016 8:55:27 PM  
 Time Spent: 00:00:51  
 IP Address: 107.77.173.11

#4

COMPLETE



Collector: Web Link 2 (Web Link)  
 Started: Tuesday, March 15, 2016 10:44:32 PM  
 Last Modified: Tuesday, March 15, 2016 11:04:38 PM  
 Time Spent: 00:20:05  
 IP Address: 70.130.131.151

PAGE 1: Public Input Meeting #1 Feedback

Q1: Are you a resident of Bellefontaine Neighbors	Yes
Q2: How often would you say you visit Bissell Hills Park?	Monthly
Q3: How do you use the park? What amenities or activities do you use in the park?	Respondent skipped this question
Q4: What improvements would you like to see made to Bissell Hills Park? Why?	Respondent skipped this question
Q5: Please provide your thoughts on Concept A overall, or the individual elements within the plan. Individual elements may include the locations or types of shelters, playgrounds, sports courts and fields, trails, landscape, parking, etc.	Respondent skipped this question
Q6: Please provide your thoughts on Concept B overall, or the individual elements within the plan. Individual elements may include the locations or types of shelters, playgrounds, sports courts and fields, trails, landscape, parking, etc.	Respondent skipped this question
Q7: Please provide your thoughts on Concept C overall, or the individual elements within the plan. Individual elements may include the locations or types of shelters, playgrounds, sports courts and fields, trails, landscape, parking, etc.	Respondent skipped this question
Q8: Please provide any comments regarding items not included in the concepts, or general comments regarding the future of Bissell Hills Park ?	Respondent skipped this question

PAGE 1: Public Input Meeting #1 Feedback

Q1: Are you a resident of Bellefontaine Neighbors	Yes
Q2: How often would you say you visit Bissell Hills Park?	Never
Q3: How do you use the park? What amenities or activities do you use in the park?	Respondent skipped this question
Q4: What improvements would you like to see made to Bissell Hills Park? Why?	Respondent skipped this question
Q5: Please provide your thoughts on Concept A overall, or the individual elements within the plan. Individual elements may include the locations or types of shelters, playgrounds, sports courts and fields, trails, landscape, parking, etc.	Respondent skipped this question
Q6: Please provide your thoughts on Concept B overall, or the individual elements within the plan. Individual elements may include the locations or types of shelters, playgrounds, sports courts and fields, trails, landscape, parking, etc.	Respondent skipped this question
Q7: Please provide your thoughts on Concept C overall, or the individual elements within the plan. Individual elements may include the locations or types of shelters, playgrounds, sports courts and fields, trails, landscape, parking, etc.	Respondent skipped this question
Q8: Please provide any comments regarding items not included in the concepts, or general comments regarding the future of Bissell Hills Park ?	

I think the money could be better used on more vital services. There are many beautiful parks in St Louis county.

# ONLINE SURVEY RESULTS

City of Bellefontaine Neighbors - Bissell Hills Park Master Plan

City of Bellefontaine Neighbors - Bissell Hills Park Master Plan

#5

COMPLETE



Collector: Web Link 2 (Web Link)  
 Started: Wednesday, March 16, 2016 6:11:27 AM  
 Last Modified: Wednesday, March 16, 2016 6:18:05 AM  
 Time Spent: 00:06:38  
 IP Address: 24.217.238.177

#6

COMPLETE



Collector: Web Link 2 (Web Link)  
 Started: Wednesday, March 16, 2016 11:14:40 AM  
 Last Modified: Wednesday, March 16, 2016 11:18:38 AM  
 Time Spent: 00:03:57  
 IP Address: 99.48.234.154

PAGE 1: Public Input Meeting #1 Feedback

PAGE 1: Public Input Meeting #1 Feedback

Q1: Are you a resident of Bellefontaine Neighbors  Yes

Q1: Are you a resident of Bellefontaine Neighbors  Yes

Q2: How often would you say you visit Bissell Hills Park?  Never

Q2: How often would you say you visit Bissell Hills Park?  Monthly

Q3: How do you use the park? What amenities or activities do you use in the park?

Q3: How do you use the park? What amenities or activities do you use in the park?

n/a

Walking

Q4: What improvements would you like to see made to Bissell Hills Park? Why? *Respondent skipped this question*

Q4: What improvements would you like to see made to Bissell Hills Park? Why? *Respondent skipped this question*

Q5: Please provide your thoughts on Concept A overall, or the individual elements within the plan. Individual elements may include the locations or types of shelters, playgrounds, sports courts and fields, trails, landscape, parking, etc.

Q5: Please provide your thoughts on Concept A overall, or the individual elements within the plan. Individual elements may include the locations or types of shelters, playgrounds, sports courts and fields, trails, landscape, parking, etc. *Respondent skipped this question*

not much different than what is there now.

Q6: Please provide your thoughts on Concept B overall, or the individual elements within the plan. Individual elements may include the locations or types of shelters, playgrounds, sports courts and fields, trails, landscape, parking, etc.

Q6: Please provide your thoughts on Concept B overall, or the individual elements within the plan. Individual elements may include the locations or types of shelters, playgrounds, sports courts and fields, trails, landscape, parking, etc. *Respondent skipped this question*

I like the fitness trail, not sure about the basketball court. it would keep some of the kids from playing ball in the streets, but could bring other problems to the park.

Q7: Please provide your thoughts on Concept C overall, or the individual elements within the plan. Individual elements may include the locations or types of shelters, playgrounds, sports courts and fields, trails, landscape, parking, etc.

Q7: Please provide your thoughts on Concept C overall, or the individual elements within the plan. Individual elements may include the locations or types of shelters, playgrounds, sports courts and fields, trails, landscape, parking, etc.

this seems like the best concept. i don't currently see much use of the park outside of the shelter area.

I do like this concept because it offers diversity of things to do.

Q8: Please provide any comments regarding items not included in the concepts, or general comments regarding the future of Bissell Hills Park? *Respondent skipped this question*

Q8: Please provide any comments regarding items not included in the concepts, or general comments regarding the future of Bissell Hills Park? *Respondent skipped this question*





# ONLINE SURVEY RESULTS

City of Bellefontaine Neighbors - Bissell Hills Park Master Plan

City of Bellefontaine Neighbors - Bissell Hills Park Master Plan

#7

COMPLETE



Collector: Web Link 2 (Web Link)  
 Started: Wednesday, March 16, 2016 11:33:39 AM  
 Last Modified: Wednesday, March 16, 2016 11:39:11 AM  
 Time Spent: 00:05:32  
 IP Address: 204.184.47.235

#8

COMPLETE



Collector: Web Link 2 (Web Link)  
 Started: Wednesday, March 16, 2016 11:32:38 AM  
 Last Modified: Wednesday, March 16, 2016 11:41:59 AM  
 Time Spent: 00:09:21  
 IP Address: 12.45.192.132

PAGE 1: Public Input Meeting #1 Feedback

PAGE 1: Public Input Meeting #1 Feedback

Q1: Are you a resident of Bellefontaine Neighbors  Yes

Q1: Are you a resident of Bellefontaine Neighbors  Yes

Q2: How often would you say you visit Bissell Hills Park?  Never

Q2: How often would you say you visit Bissell Hills Park?  Yearly

Q3: How do you use the park? What amenities or activities do you use in the park?

Q3: How do you use the park? What amenities or activities do you use in the park?

I did not know there is a park available for public use

When my kids were younger we used it OFTEN...now basically for the pavilion.

Q4: What improvements would you like to see made to Bissell Hills Park? Why? *Respondent skipped this question*

Q4: What improvements would you like to see made to Bissell Hills Park? Why?

Q5: Please provide your thoughts on Concept A overall, or the individual elements within the plan. Individual elements may include the locations or types of shelters, playgrounds, sports courts and fields, trails, landscape, parking, etc.

new shelter, restrooms...a splash pad, flowers, a walking and/or biking trail, ball field, a sports court, benches, new trash receptacles, new picnic tables

This model limits the use of the property to primarily softball, basketball and a playground

Q5: Please provide your thoughts on Concept A overall, or the individual elements within the plan. Individual elements may include the locations or types of shelters, playgrounds, sports courts and fields, trails, landscape, parking, etc.

Q6: Please provide your thoughts on Concept B overall, or the individual elements within the plan. Individual elements may include the locations or types of shelters, playgrounds, sports courts and fields, trails, landscape, parking, etc.

I like the ball field in the back, the large seating/eating area in the middle and that multi-sport court!

The walking trail is a wonderful addition that can be used by more people than the softball field. The rain garden is a nice touch along with the basketball courts and the landscaping.

Q6: Please provide your thoughts on Concept B overall, or the individual elements within the plan. Individual elements may include the locations or types of shelters, playgrounds, sports courts and fields, trails, landscape, parking, etc.

Q7: Please provide your thoughts on Concept C overall, or the individual elements within the plan. Individual elements may include the locations or types of shelters, playgrounds, sports courts and fields, trails, landscape, parking, etc.

I LOVE the flowers/landscaping, the large pavilion area and the fitness trail.

I like this concept best. Removing the basketball courts makes the area more family friendly. Will the adventure playground have some features that are accessible to disabled people?

Q7: Please provide your thoughts on Concept C overall, or the individual elements within the plan. Individual elements may include the locations or types of shelters, playgrounds, sports courts and fields, trails, landscape, parking, etc.

Q8: Please provide any comments regarding items not included in the concepts, or general comments regarding the future of Bissell Hills Park? *Respondent skipped this question*

Q8: Please provide any comments regarding items not included in the concepts, or general comments regarding the future of Bissell Hills Park?

I am a long-time resident and am REALLY looking forward to seeing the park renewed!!

# ONLINE SURVEY RESULTS

City of Bellefontaine Neighbors - Bissell Hills Park Master Plan

City of Bellefontaine Neighbors - Bissell Hills Park Master Plan

#9

COMPLETE



Collector: Web Link 2 (Web Link)  
 Started: Wednesday, March 16, 2016 3:17:07 PM  
 Last Modified: Wednesday, March 16, 2016 3:21:44 PM  
 Time Spent: 00:04:36  
 IP Address: 66.87.72.49

#10

COMPLETE



Collector: Web Link 2 (Web Link)  
 Started: Wednesday, March 16, 2016 5:22:25 PM  
 Last Modified: Wednesday, March 16, 2016 5:26:31 PM  
 Time Spent: 00:04:06  
 IP Address: 108.72.81.179

PAGE 1: Public Input Meeting #1 Feedback

PAGE 1: Public Input Meeting #1 Feedback

- Q1: Are you a resident of Bellefontaine Neighbors *Respondent skipped this question*
- Q2: How often would you say you visit Bissell Hills Park? Daily
- Q3: How do you use the park? What amenities or activities do you use in the park?  
 Trail to walk
- Q4: What improvements would you like to see made to Bissell Hills Park? Why?  
 Restrooms at different spots
- Q5: Please provide your thoughts on Concept A overall, or the individual elements within the plan. Individual elements may include the locations or types of shelters, playgrounds, sports courts and fields, trails, landscape, parking, etc.  
 Very nice
- Q6: Please provide your thoughts on Concept B overall, or the individual elements within the plan. Individual elements may include the locations or types of shelters, playgrounds, sports courts and fields, trails, landscape, parking, etc.  
 Very nice
- Q7: Please provide your thoughts on Concept C overall, or the individual elements within the plan. Individual elements may include the locations or types of shelters, playgrounds, sports courts and fields, trails, landscape, parking, etc.  
 Very nice
- Q8: Please provide any comments regarding items not included in the concepts, or general comments regarding the future of Bissell Hills Park ?  
 Maintain the park

- Q1: Are you a resident of Bellefontaine Neighbors Yes
- Q2: How often would you say you visit Bissell Hills Park? Monthly
- Q3: How do you use the park? What amenities or activities do you use in the park?  
 walk dog, sit on bench
- Q4: What improvements would you like to see made to Bissell Hills Park? Why?  
 dog area
- Q5: Please provide your thoughts on Concept A overall, or the individual elements within the plan. Individual elements may include the locations or types of shelters, playgrounds, sports courts and fields, trails, landscape, parking, etc.  
 Iuv it
- Q6: Please provide your thoughts on Concept B overall, or the individual elements within the plan. Individual elements may include the locations or types of shelters, playgrounds, sports courts and fields, trails, landscape, parking, etc.  
 looks nice too
- Q7: Please provide your thoughts on Concept C overall, or the individual elements within the plan. Individual elements may include the locations or types of shelters, playgrounds, sports courts and fields, trails, landscape, parking, etc. *Respondent skipped this question*
- Q8: Please provide any comments regarding items not included in the concepts, or general comments regarding the future of Bissell Hills Park ? *Respondent skipped this question*





# ONLINE SURVEY RESULTS

City of Bellefontaine Neighbors - Bissell Hills Park Master Plan

City of Bellefontaine Neighbors - Bissell Hills Park Master Plan

#11

COMPLETE



Collector: Web Link 2 (Web Link)  
 Started: Wednesday, March 16, 2016 6:28:56 PM  
 Last Modified: Wednesday, March 16, 2016 6:32:03 PM  
 Time Spent: 00:05:07  
 IP Address: 99.174.68.248

#12

COMPLETE



Collector: Web Link 2 (Web Link)  
 Started: Wednesday, March 16, 2016 8:38:38 PM  
 Last Modified: Wednesday, March 16, 2016 8:44:24 PM  
 Time Spent: 00:05:45  
 IP Address: 97.85.161.17

PAGE 1: Public Input Meeting #1 Feedback

PAGE 1: Public Input Meeting #1 Feedback

Q1: Are you a resident of Bellefontaine Neighbors	Yes
Q2: How often would you say you visit Bissell Hills Park?	Weekly
Q3: How do you use the park? What amenities or activities do you use in the park?	Respondent skipped this question
Q4: What improvements would you like to see made to Bissell Hills Park? Why?	Respondent skipped this question
Q5: Please provide your thoughts on Concept A overall, or the individual elements within the plan. Individual elements may include the locations or types of shelters, playgrounds, sports courts and fields, trails, landscape, parking, etc.	I like "A" think is the best one!!!
Q6: Please provide your thoughts on Concept B overall, or the individual elements within the plan. Individual elements may include the locations or types of shelters, playgrounds, sports courts and fields, trails, landscape, parking, etc.	Respondent skipped this question
Q7: Please provide your thoughts on Concept C overall, or the individual elements within the plan. Individual elements may include the locations or types of shelters, playgrounds, sports courts and fields, trails, landscape, parking, etc.	Respondent skipped this question
Q8: Please provide any comments regarding items not included in the concepts, or general comments regarding the future of Bissell Hills Park ?	Respondent skipped this question

Q1: Are you a resident of Bellefontaine Neighbors	Yes
Q2: How often would you say you visit Bissell Hills Park?	Monthly
Q3: How do you use the park? What amenities or activities do you use in the park?	Playground
Q4: What improvements would you like to see made to Bissell Hills Park? Why?	Better playground equipment like what Stl county has at the park behind the police department... The parent toddler swings are perfect...
Q5: Please provide your thoughts on Concept A overall, or the individual elements within the plan. Individual elements may include the locations or types of shelters, playgrounds, sports courts and fields, trails, landscape, parking, etc.	I despise the idea of outdoor basketball courts at this location... I feel like it would draw a bad crowd that would be unsupervised!
Q6: Please provide your thoughts on Concept B overall, or the individual elements within the plan. Individual elements may include the locations or types of shelters, playgrounds, sports courts and fields, trails, landscape, parking, etc.	Love a "fitness trail" concept!!! No basketball please!
Q7: Please provide your thoughts on Concept C overall, or the individual elements within the plan. Individual elements may include the locations or types of shelters, playgrounds, sports courts and fields, trails, landscape, parking, etc.	This is the BEST concept! I feel with more trails and a bigger playground, it will be more family friendly!!! Without a basketball court, there won't be large INTIMIDATING crowds gathering. I have two very young children and have seen the basketball crowds that play here and would never take my kids to a park where they are playing... Too dangerous.
Q8: Please provide any comments regarding items not included in the concepts, or general comments regarding the future of Bissell Hills Park ?	100% love the last concept!!! Sculptures and trails draw photography crowds and family fun... Adding a playground to this would very much be more appealing to the family type crowds! Especially with young kids!

# ONLINE SURVEY RESULTS

City of Bellefontaine Neighbors - Bissell Hills Park Master Plan

City of Bellefontaine Neighbors - Bissell Hills Park Master Plan

#13

COMPLETE



Collector: Web Link 2 (Web Link)  
 Started: Wednesday, March 16, 2016 10:00:56 PM  
 Last Modified: Wednesday, March 16, 2016 10:03:03 PM  
 Time Spent: 00:02:07  
 IP Address: 71.10.170.113

#14

COMPLETE



Collector: Web Link 2 (Web Link)  
 Started: Friday, March 18, 2016 10:11:33 AM  
 Last Modified: Friday, March 18, 2016 10:50:39 AM  
 Time Spent: 00:39:06  
 IP Address: 107.134.250.255

PAGE 1: Public Input Meeting #1 Feedback

PAGE 1: Public Input Meeting #1 Feedback

Q1: Are you a resident of Bellefontaine Neighbors	Yes
Q2: How often would you say you visit Bissell Hills Park?	Weekly
Q3: How do you use the park? What amenities or activities do you use in the park?	Respondent skipped this question
Q4: What improvements would you like to see made to Bissell Hills Park? Why?	Respondent skipped this question
Q5: Please provide your thoughts on Concept A overall, or the individual elements within the plan. Individual elements may include the locations or types of shelters, playgrounds, sports courts and fields, trails, landscape, parking, etc.	Respondent skipped this question
Q6: Please provide your thoughts on Concept B overall, or the individual elements within the plan. Individual elements may include the locations or types of shelters, playgrounds, sports courts and fields, trails, landscape, parking, etc.	I prefer Concept B. I think many individuals would utilize the basketball courts. I also like the rain garden
Q7: Please provide your thoughts on Concept C overall, or the individual elements within the plan. Individual elements may include the locations or types of shelters, playgrounds, sports courts and fields, trails, landscape, parking, etc.	Respondent skipped this question
Q8: Please provide any comments regarding items not included in the concepts, or general comments regarding the future of Bissell Hills Park ?	Respondent skipped this question

Q1: Are you a resident of Bellefontaine Neighbors	Yes
Q2: How often would you say you visit Bissell Hills Park?	Weekly
Q3: How do you use the park? What amenities or activities do you use in the park?	playground shelter tennis courts
Q4: What improvements would you like to see made to Bissell Hills Park? Why?	enlarge the playground area: *include at least one expression swing (allows adult to swing with their small child) <a href="http://www.gametime.com/product/Prime-Time-Solo-Expression-Swing/">http://www.gametime.com/product/Prime-Time-Solo-Expression-Swing/</a> *include two G-Force swings (easier to put child into and take out of seat) <a href="https://www.especialneeds.com/g-force-swing-seat.html">https://www.especialneeds.com/g-force-swing-seat.html</a> * see playgrounds at Tower Grove Park: there are two playgrounds, one for younger children, and one for older children. These playgrounds also have some unusual pieces of equipment that kids love.
Q5: Please provide your thoughts on Concept A overall, or the individual elements within the plan. Individual elements may include the locations or types of shelters, playgrounds, sports courts and fields, trails, landscape, parking, etc.	love the fountains in the playground area, like the shelter and restroom area (especially the paved areas for chairs, like basket ball area
Q6: Please provide your thoughts on Concept B overall, or the individual elements within the plan. Individual elements may include the locations or types of shelters, playgrounds, sports courts and fields, trails, landscape, parking, etc.	like the fitness trail, the naturalized drainage area, and rain garden
Q7: Please provide your thoughts on Concept C overall, or the individual elements within the plan. Individual elements may include the locations or types of shelters, playgrounds, sports courts and fields, trails, landscape, parking, etc.	like how it connects to the conservation area, like the birdhouses and sculptures
Q8: Please provide any comments regarding items not included in the concepts, or general comments regarding the future of Bissell Hills Park ?	The playground area needs to be enlarged. What we have now does not allow smaller children a safe place to play when there are bigger children at the playground at the same time. Many children who use this playground now like to play dodge ball. This really makes it unsafe for younger children when the older children are playing dodge ball. You may want to consult with Christine Kulla-Branz (a resident/Roxton). She has experience in designing playgrounds.





# ONLINE SURVEY RESULTS

City of Bellefontaine Neighbors - Bissell Hills Park Master Plan

City of Bellefontaine Neighbors - Bissell Hills Park Master Plan

#15

COMPLETE



Collector: Web Link 2 (Web Link)  
 Started: Monday, March 21, 2016 8:23:32 AM  
 Last Modified: Monday, March 21, 2016 10:24:13 AM  
 Time Spent: 02:00:41  
 IP Address: 97.87.204.130

#16

COMPLETE



Collector: Web Link 2 (Web Link)  
 Started: Wednesday, March 23, 2016 8:28:42 AM  
 Last Modified: Wednesday, March 23, 2016 8:37:35 AM  
 Time Spent: 00:08:53  
 IP Address: 97.87.204.130

PAGE 1: Public Input Meeting #1 Feedback

PAGE 1: Public Input Meeting #1 Feedback

Q1: Are you a resident of Bellefontaine Neighbors  Yes

Q1: Are you a resident of Bellefontaine Neighbors  Yes

Q2: How often would you say you visit Bissell Hills Park?  Weekly

Q2: How often would you say you visit Bissell Hills Park?  Monthly

Q3: How do you use the park? What amenities or activities do you use in the park?

The shelter and rest rooms

Q3: How do you use the park? What amenities or activities do you use in the park?

We like taking our dog for a walk and letting him run a little bit. Also, I have gone to numerous BBQs at the pavilion.

Q4: What improvements would you like to see made to Bissell Hills Park? Why?

The shelter and rest room need improvement

Q4: What improvements would you like to see made to Bissell Hills Park? Why?

I would love to see an updated pavilion; a walking path around the park along with benches; landscaping with natural habitat features; and a kid-friendly playground.

Q5: Please provide your thoughts on Concept A overall, or the individual elements within the plan. Individual elements may include the locations or types of shelters, playgrounds, sports courts and fields, trails, landscape, parking, etc.

I think the park is too small for a divided shelter

Q5: Please provide your thoughts on Concept A overall, or the individual elements within the plan. Individual elements may include the locations or types of shelters, playgrounds, sports courts and fields, trails, landscape, parking, etc.

I like the multi-sport concept although not the softball overlay. Over the years, I haven't seen anyone utilizing the fields. I would like to see an open space for some sort of pick-up game or wiffle ball.

Q6: Please provide your thoughts on Concept B overall, or the individual elements within the plan. Individual elements may include the locations or types of shelters, playgrounds, sports courts and fields, trails, landscape, parking, etc.

I like this concept no sure on the basketball court

Q6: Please provide your thoughts on Concept B overall, or the individual elements within the plan. Individual elements may include the locations or types of shelters, playgrounds, sports courts and fields, trails, landscape, parking, etc.

I love the fitness trail and destination playground. I do not like the basketball courts. It seems too limiting.

Q7: Please provide your thoughts on Concept C overall, or the individual elements within the plan. Individual elements may include the locations or types of shelters, playgrounds, sports courts and fields, trails, landscape, parking, etc.

I like this concept the best

Q7: Please provide your thoughts on Concept C overall, or the individual elements within the plan. Individual elements may include the locations or types of shelters, playgrounds, sports courts and fields, trails, landscape, parking, etc.

Again, I love the fitness trail and the adventure playground, but I would like to have the naturalized open space not as big.

Q8: Please provide any comments regarding items not included in the concepts, or general comments regarding the future of Bissell Hills Park? *Respondent skipped this question*

Q8: Please provide any comments regarding items not included in the concepts, or general comments regarding the future of Bissell Hills Park?

Thank you for your help with trying to give the community a much needed uplift to our park.



# PUBLIC MEETING #2 | FINAL CONCEPT

